



LIVE THE BRAAI LIFE

PORTABLE STOVE

MODEL No: 1150



USER INSTRUCTIONS



NOTE! PRODUCT MAY VARY FROM ILLUSTRATIONS

503-0747 LEV1







CAUTION
For outdoor use only!
Not for household use.

GB

IMPORTANT

Read these instructions for use carefully so as to familiarize yourself with the appliance before connecting it to its gas container. Keep these instructions for future reference

1. Introduction

- This appliance complies with SANS 1539:2017.
- This appliance shall be used exclusively on gas cartridges only.
- **Appliance category:** Vapour pressure butane (LPG).
- **Nominal consumption:** 200 g/hr
- **Nominal Heat Input:** 2.75 kW
- Outlet pressure of the valve 7.65 kPa
- This appliance uses a No.65 jet.
- **Maximum pot size:** Diameter 26cm.

2. Safety information

- DO NOT USE THE APPLIANCE IF IT HAS A DAMAGED OR WORN SEAL. REPLACE IT.
- Do not use an appliance that is leaking, damaged or that does not operate properly.
- The appliance shall only be used in a well-ventilated location, if used in-doors.
- Always operate the appliance on a firm level surface.
- Ensure the appliance is used away from flammable materials. Minimum safe distances are: above the appliance 1.2m. At the rear and sides 600mm (See Fig.1).
- Gas cartridges must be fitted or changed outdoors, away from any source of ignition such as naked flames, electric fires and away from other people.
- If there is a leak on your appliance (smell of gas), immediately close the gas supply by closing the control valve and take it outside into a well-ventilated flame free location where the leak may be detected and stopped. Do not try to detect leaks using a flame. Soapy water should be used.
- Never leave the appliance unattended when lit.
- In the event of light back (ignition inside the burner tube or chamber), immediately turn off the gas supply by closing the control valve. After the flame is extinguished, re-light the appliance. Should the flame persistently light back, return the product to your authorised CADAC repair agent. Do not use your appliance until it has been repaired or is safe to do so.
- Do not modify the appliance. Do not use it for anything for which it has not been designed.
- During use, parts of the appliance will become hot. Avoid touching hot parts with bare hands. The use of oven gloves is recommended.
- Keep young children away from the appliance at all times.

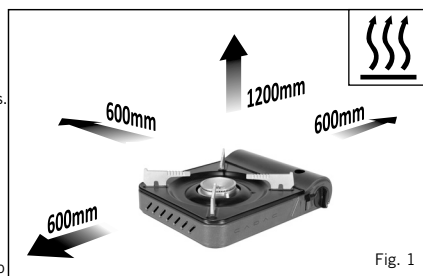

Fig. 1

3. Fitting and changing the gas cartridge

- Make sure the control knob is turned all the way clockwise to the "OFF" position. Make sure the cartridge locking lever is in the "UNLOCK" position or you will not be able to fit the gas cartridge. (Fig. 2)
- Open the gas cartridge cover and insert the cartridge so that the regulator guide is aligned with the notch in the cartridge rim. (Fig. 3)
- Push down on the cartridge lever to the "FUEL LOCK" position. (Fig. 4)
- CAUTION: When connecting or disconnecting the gas cartridge, be sure that no external sources of ignition are present.

NOTE

- Check that the seals between the appliance and the gas cartridge are in place and in good condition before connecting the gas cartridge.
- DO NOT use this appliance if it has damaged or worn seals.
- DO NOT use this appliance if it is leaking, damaged or does not work properly.

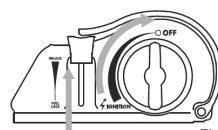
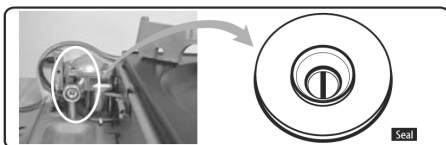

Fig. 2

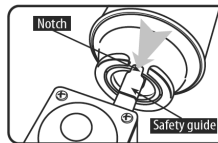

Fig. 3

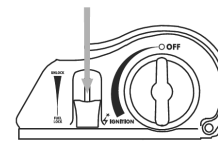
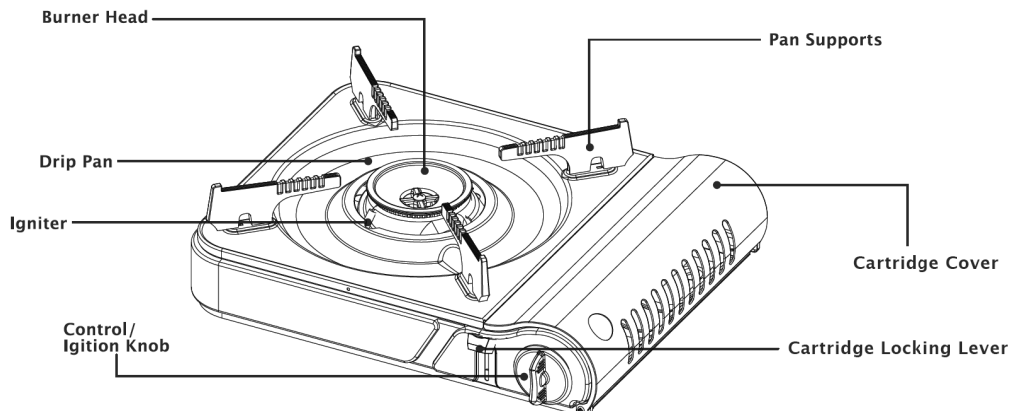

Fig. 4





4. Operating the Appliance

Lighting the stove

- NOTE: Close the cartridge cover before lighting. Not closing the cover can cause the cartridge to overheat.
- Turn the control knob counterclockwise until you hear a click indicating that a spark has been produced. (Fig. 5)
- If the stove does not light, turn the control knob back to the "OFF" position and repeat.
- If after three failed attempts, the stove does not light, turn the control knob to the "OFF" position and move the cartridge lever to the "UNLOCK" position.
- Open the cartridge cover and remove the cartridge. Shake the cartridge to see if it is empty. If empty, replace the cartridge by following the steps under section 3.

To adjust heat

- Flame can be controlled by turning the ignition knob between the "IGNITION" and "OFF" position.

Extinguishing

- Turn the ignition knob to "OFF" to shut off fuel supply (Fig. 6). Wait until the flame is fully extinguished before performing the next step.
- Raise the cartridge lock lever to "UNLOCK" and remove the gas cartridge from the compartment (Fig. 2).
- NOTE: Do not leave the gas cartridge inside the unit when not in use.

The automatic safety shut-off device activation

- When used in high temperature areas, such as the beach during summer or in a hot room, the internal pressure of the cartridge may rise to more than 500-700 Kpa (normal pressure = 200-300 kPa). This will activate the automatic safety shut-off device inside the regulator.
- Remove the gas cartridge from the compartment. If the stove had been in use and was working properly, the butane can should be cold to the touch. If it is not and feels warm, see the precautions section in this manual and confirm if you are using the stove correctly.
- Turn the ignition knob to "IGNITION" to release any excess gas inside the regulator. Repeat the steps for inserting the gas cartridge after it has cooled down.

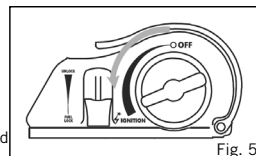

Fig. 5

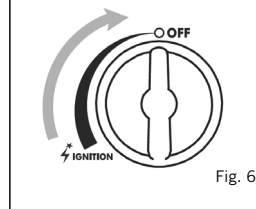

Fig. 6

5. Precautions

- NOTE: The jet is a sealed unit, if problems occur contact your local CADAC distributor for inspection / repair.
- Never leave the stove unattended when hot or when in use.
- Do not modify the appliance.
- CAUTION: Accessible parts may become very hot. Keep young children away from the appliance at all times.
- Keep the stove area clear and free of combustible materials, gasoline and other flammable vapors and liquids.
- Do not obstruct the flow of ventilation and combustion air around the appliance.
- Keep the igniter and burner head gap free from debris for easy lighting.
- Clean stove frequently to avoid grease build up and as necessary.
- Burner flame should be blue with a hint of yellow on the tip.

Precautions for fuel use

- Check that the cartridge is empty before changing it (shake to hear noise made by the liquid).
- Check the seals before connecting a new gas cartridge to the appliance.
- Change the gas cartridge outside and away from people. Gas cartridge shall be changed in a well-ventilated location, preferably outside, away from any sources of ignition such as naked flames, pilots, electric fires and away from other people.
- Never try to remove the butane cartridge whilst the stove is lit.
- Never try to refill the disposable butane cartridge.
- Avoid any strong impact that might damage the cartridge or valve.
- Keep the cap cover on the cartridge when not in use.
- Do not dispose of the cartridge into a fire. Even though the cartridge seems empty, vapors may still remain.





Fire hazards

- Never store butane near high heat, open flames, direct sunlight, or any location that can exceed 40 C.
- Never install or remove butane cartridge while the stove flame is ignited or near any source of ignition such as another stove in use, pilot lights, chafing dish fuels or any open flame or spark.
- During operation, this appliance can also be a source of ignition. Do not use near explosive or combustibles such as gasoline, paint thinners, explosive vapors or other cans of butane.
- For use on non-combustible surfaces.

Stove precautions

- Do not carry the unit while it is burning.
- Do not touch the unit while in use or just after use.
- Do not overheat the stove.
- Do not use for drying clothes.
- Do not use two or more stoves adjacent to each other.
- Do not use as a heater.
- Never use the stove without the pan support.
- Do not use a pan larger than 26cm as this will cover the fuel compartment and cause the canister to overheat.
- Do not use two or more stoves covered by a single pan or metal sheet.
- Never use aluminum foil as a cooking container on the stove.
- Never use ceramic cookware.
- The appliance must be operated on a horizontal surface.
- If sand, mud, stones or other debris are present, place a piece of noncombustible matting that is larger than the stove, on the ground and place the stove on top of the matting. This is to prevent these items from entering the stove.
- Avoid direct sunlight or other heat sources that could exceed 40 C.
- Never heat an empty pan/pot.
- Do not use in windy conditions as the flame may be extinguished. Gas will continue to flow creating a hazardous condition.
- Never use the stove near flammable materials or combustible vapors.
- Do not use this stove below shelves or where there is a danger of falling objects.
- If there is a leak on your appliance (smell of gas), take it outside immediately into a well-ventilated flame free location where the leak may be detected and stopped. If you wish to check for leaks on your appliance, do it outside. Do not try to detect leaks using a flame, use soapy water.
- This appliance must only be serviced by an authorised person.

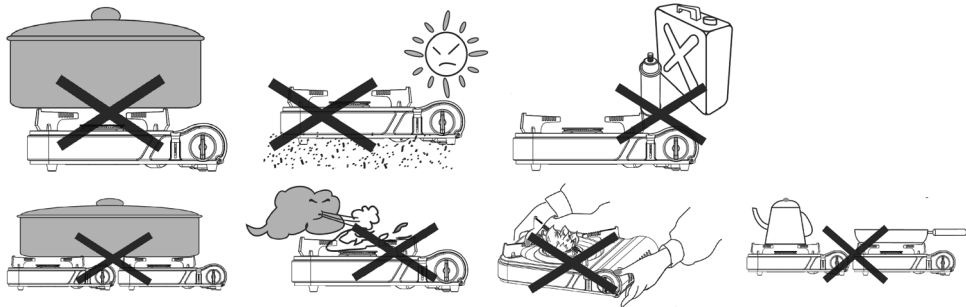
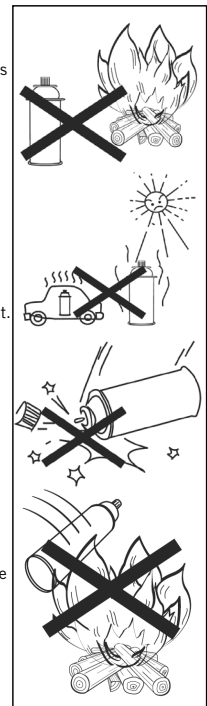



6. Troubleshooting

- A normal flame is blue and may have an orange or yellow tip. If the flame is completely yellow, it may be that the jet is not securely fitted. Re-tighten to give a gas tight seal.
- If the flame power drops or the gas will not light, check that the gas cartridge still contains gas (shake to hear the noise made by the liquid). If there is still gas, the jet might have become blocked or partially blocked.

Problem Cause	No Ignition	No Burning	Unstable Flame	Uneven Flame	Slow Burning	Gas Smell	Stopped Working while in Use	Continued Burning	Solution
Lack of fuel	●	●			●		●		Replace Cartridge
Piezo plug dirty	●								Clean spark point
Dirty burner	●	●	●	●	●				Clean burner
Cartridge misaligned	●	●	●		●	●			Reset correctly
Dirty burner or empty cartridge	●	●		●	●				Request for inspection/service
Faulty knob mechanism	●					●		●	Request for inspection/repair
Internal gas pressure too high							●		Cool down gas
Safety device activated	●							●	Request for inspection/service
Improper setting of spark point	●								Set spark point to 2mm (5/64") away from burner





7. Cleaning and Storage

- **DO NOT** immerse in water as this will allow water to get into the burner and primary air holes, causing the appliance to malfunction.
- Use a soft cloth to clean greasy parts of the stove with soap and water.
- Do not use abrasive cleaners as this will cause permanent damage to the surface.
- Keep your stove clean using a stiff brush to clean the burner head.
- Never store butane cartridges near a heat source, open flame or any source of ignition.
- Never store butane in direct sunlight.
- Never store in any closed space that may reach temperatures of 40°C.

8. Returning the Appliance for Repair or Service

- This appliance has a 2 year guarantee against factory fault.
- Do not modify the appliance. This will cause your guarantee to become void.
- If you cannot rectify any fault by following these instructions, please return the appliance to your local CADAC distributor for inspection / repair.

**CADAC INTERNATIONAL**

P.O. Box 43196,
Industria, 2042 South Africa
Tel: +27 11 470 6600
Email: info@cadac.co.za
www.cadacinternational.com

CADAC UK

1 Open Barn
Backridge Farm Business Centre
Twitter Lane, Bashall Eaves
Clitheroe, BB7 3LQ, UK
Tel: +44 333 200 0363
Email: info@cadacuk.com
www.cadacinternational.com

CADAC USA

50 Mountain View Road
Warren, NJ, 07059
Tel: 908 604 0677
Email: cadacusa@yahoo.com

CADAC IRAN

Robin Bazarganan Carin Co.
Unit D, 6th Floor, Negin Zafar
Building, No.1327,
Shariati Street, Tehran, Iran
Tel: +98 21 276 00 781
Mail: info@cadac.ir

CADAC MALAYSIA

Katrin BJ SDN BHD (90816-M)
No 12, Jalan TP2, Taman
Perindustrian SIME UEP,
47600 Subang Jaya, Selangor
Darul, Ehsan, Malaysia.
Tel (603) 8023 3939
info@katrinbj.com

CADAC MOZAMBIQUE

Exclusive Brands Africa
492 Avenida Namaacha
Maputo, Mozambique
Tel: +258 21 406254
www.cadac.co.mz

CADAC U.A.E.

Supreme Impex General Trading
LLC Office No. 1801-7 Latifa
Tower Sheikh Zayed Road
Dubai, UAE

CADAC HONG KONG

Everything Under The Sun
902 Horizon Plaza, 2 Lee Wing Street,
Ap Lei Chau, HK
Tel :+852 2554 9088
Email: info@everythingunderthesun.com.hk
www. everythingunderthesun.com.hk

CADAC EUROPE

Ratio 26, 6921 RW Duiven
The Netherlands
Tel: +31 26 319 7740
Email: info@cadaceurope.com
www.cadacinternational.com

CADAC SCANDINAVIA

Millarco International A/S
Rokhøj 26
8520 Lystrup, Denmark
Phone: +45 87 43 42 00
millarco@millarco.dk
www.millarco.com

CADAC AUSTRALIA

CADAC-BBQ Pty Ltd, Australia
Tel: +61 420 503 967
Customer Care: 1300 135 011
Email: info@cadacbbq.com.au
www.cadacbbq.com.au

CADAC DENMARK

Camper Fritid
Industrivej 11
6640 Lunderskov, Denmark
Tel.: +45 7558 5255
Email: info@camper.dk
www.camper.dk

CADAC CHINA

Room 807, Huayue International
Building, No.255 Tiangao Road,
South
Yinzhou business district,
Ningbo, China
Tel:+86 574 87723937
Email: info@cadac.com.cn

CADAC MONTENEGRO

Cetinjski put bb,novi City
kvart.zg.1,lokal 6
81101 Podgorica, Monte Negro
Tel.+38269020063
Email: coca@t-com.me

CADAC SWEDEN & NORWAY

KAMA FRITID AB
0046 36 353700
info@kamafritid.se

CADAC GERMANY

Ratio 26, 6921 RW Duiven
The Netherlands
Tel: +31 26 319 7740
Email: info@cadaceurope.com
www.cadacinternational.com

CADAC Czech Rep.

RÖSLER Praha spol. s r.o.
K Horkám 19/21
102 00 Praha 10 Česká republika
Tel: +420 267 188 011
Email: info@rosler.cz
www.rosler.cz

CADAC ISRAEL

Chagim
PO.box 8122819
Hayarden 13, Yavne, Israel
Tel: +972-73-2595666
Email: grill@i-berman.co.il

CADAC SAUDI ARABIA

Noble Ventures
34 Ibn Saad Al Kathib Street,
Khalidiya,
Jeddah, 21435,
Kingdom of Saudi Arabia
info@nobleventures.com

CADAC ZIMBABWE

Exclusive Brands Africa
Unit 8 Birkenhead Park
43 Josiah Chinamano Street
Belmont, Bulawayo
Tel: +263 971 740 (Bul)
Tel: +263 479 2564 (Har)
www.cadac.co.zw

CADAC SOUTH EAST EUROPE

Bulevar oslobođenja 285
Tel: +381 11 339 2700
Email: sinisaj@cadac.rs
www.cadac.rs

CADAC FINLAND

OY KAMA
00358 207920 310
info@kamafritid.fi

CADAC FRANCE

Le Viallon, 42520 Veranne
France
Tel: +33 4 74 78 13 65
Email : info@cadaceurope.com
www.cadacinternational.com

CADAC NEW ZEALAND

Riverlea Group (Pty) Ltd
2A Maui Street, Pukete,
Hamilton 3200, New Zealand
Tel: +64 7 847 0204
Email: sales@riverleagroup.co.nz
www.riverleagroup.co.nz

CADAC KOREA

Suite 502 Pika Bldg.
Hogye-Dong, Anyang-Si,
Gyeonggi-Do, South Korea
Tel: +82 31 427 5466
cadackorea@gmail.com

CADAC ITALY

Brunner SRL/GMBH
via Buoizzi, 8
39100 Bolzano (Italy)
Tel: +39 0471 542900
Email: info@brunner.it
www.brunnerinternational.com

CADAC ZAMBIA

Exclusive Brands Africa Limited
7225A Kachidza Road
Light Industrial Area
Lusaka, Zambia
Tel: +260 211 842015
Tel: +260977 345034
Email: info@ebagrp.com

CADAC POLAND

Kamai
Wola Batorska 461
32-007 Wola Batorska Poland
Tel: +48 12 635 1373
Email: handlowy@kamai.pl
www.kamai.pl

